

Products of KEG

SLPN 10E, SLUN 77, SLUN 77A, SLZN 82, SLZN 92



SLPN 10E

Characteristics

- **vandal-proof**
- stainless steel wall hung urinal with integrated infra-red electronics
- rear assembling by the mounting plate and special screws
- system reacts to the user attendance in front of the urinal at a maximum distance of 0,7 m, minimum stay time in active range is 7,5 s
- system flushes after leaving of user from active range
- adjustable flushing time 0,5 - 15,5 s
- parameters adjustment by remote control SLD 03
- automatic hygiene flushing after 24 hours non-use
- monitoring of battery capacity (for models with index B)
- material AISI - 304
- brushed finish

Dimensions

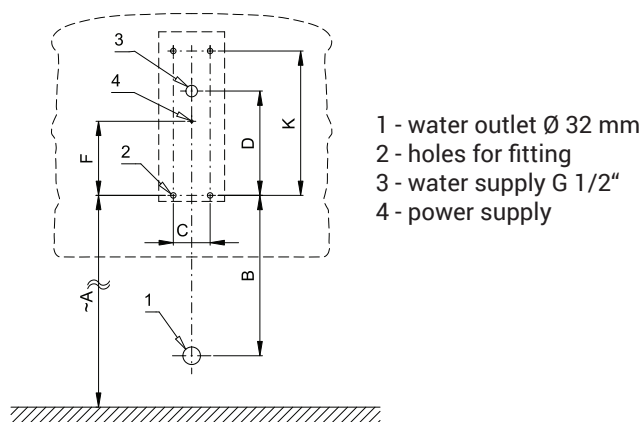

Dimensions (mm)	A	B	C	D	F	K
KEG	520	237	67	190	135	263

* for the height of the front edge of the urinal 650 mm above the floor

Technical Specification

Operating voltage

- SLPN 10E 24 V DC
- SLPN 10EB 6 V

Power input

- operating by 24 V DC 7 W
- operating by 6 V 3 W

Battery life

- 4 pcs. AA alkaline batteries approx. 2 years (100 uses per day)

Active range

- 0,6 - 0,75 m

Recommended flow pressure

- 0,1 - 0,6 MPa

Rate of flow

- 12 l/min. (inf. data)

Water inlet

- male thread G 1/2"

Supply Specification

- SLPN 10E - Supply No. 91109 stainless steel urinal with flushing head and electronics, electromagnetic valve,
SLPN 10EB - Supply No. 91105 angle valve with filter, connecting hoses, TORX screws (4 pcs.), siphon,
4 pc. AA alkaline batteries 1,5 V, 2700 mAh with battery case (SLPN 10EB)

Recommended Accessories

- SLZ 01Y - Supply No. 05012 power supply 24 V DC for operating of max. 5 pcs. of flushing units
SLZ 01Z - Supply No. 05011 power supply 24 V DC for operating of max. 9 pcs. of flushing units
SLZ 04Y - Supply No. 05042 power supply 24 V DC for DIN rail, for operating of max. 5 pcs. of flushing units
SLZ 04Z - Supply No. 05041 power supply 24 V DC for DIN rail, for operating of max. 9 pcs. of flushing units
SLZ 04X - Supply No. 10049 power supply 24 V DC for DIN rail, for operating of max. 15 pcs. of flushing units
SLZ 06 - Supply No. 05060 power supply 24 V DC for operating of max. 1 pc. of flushing unit
SLD 03 - Supply No. 07030 remote control for an adjustment of parameters
SLR 02N - Supply No. 08021 mounting frame to the plasterboard for the urinal
SLA 36 - Supply No. 06360 set of 4 pcs. alkaline batteries AA 1,5 V, 2700 mAh (for models with index B)



SLUN 77

Characteristics

- stainless steel counter top washbasin
- assembling by screws
- material AISI - 304
- brushed finish

Dimensions

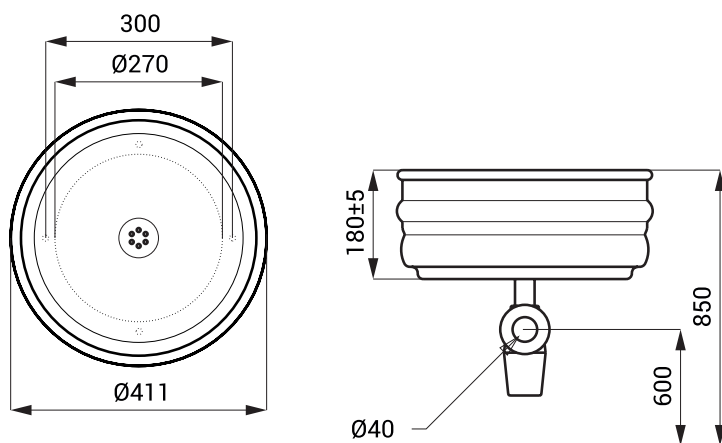

Supply Specification

SLUN 77 - Supply No. 93774 stainless steel washbasin, siphon, screw (4 pcs.), pad (4 pcs.)

Recommended Accessories

SLU 60	- Supply No. 03600	automatic washbasin mixer, 24 V DC
SLU 60B	- Supply No. 03605	automatic washbasin mixer, 6 V
SLU 42K	- Supply No. 03420	automatic wall-mounted mixer, 24 V DC
SLU 42KB	- Supply No. 03425	automatic wall-mounted mixer, 6 V
SLU 43	- Supply No. 03430	automatic wall-mounted stainless steel washbasin tap, 24 V DC
SLU 43B	- Supply No. 03435	automatic wall-mounted stainless steel washbasin tap, 6 V
SLU 43KB	- Supply No. 03431	automatic wall-mounted washbasin tap, 6 V



SLUN 77A

Characteristics

- stainless steel wall hung washbasin
- with a tap hole
- material AISI - 304
- brushed finish

Dimensions

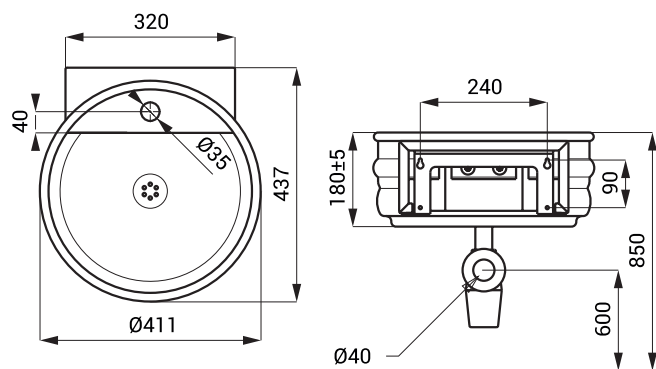

Supply Specification

SLUN 77A - Supply No. 93775 stainless steel washbasin, siphon, mounting set



SLZN 82

SLZN 82

85821

Stainless steel mirror KEG

- mounting on the wall
- dimensions 394 x 394 x 114 mm
- mirror - high polished finish
- frame - brushed finish

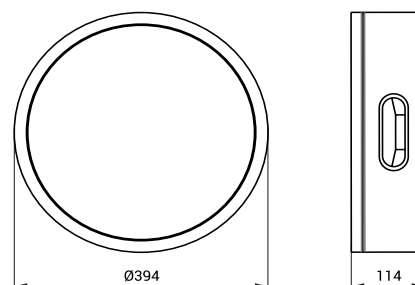



SLZN 92

Characteristics

- stainless steel bar stool
- fixed to the floor or self-standing
- dimensions 807 x Ø 405 mm
- brushed finish
- seat made of handmade oak wood

Detail:



Dimensions

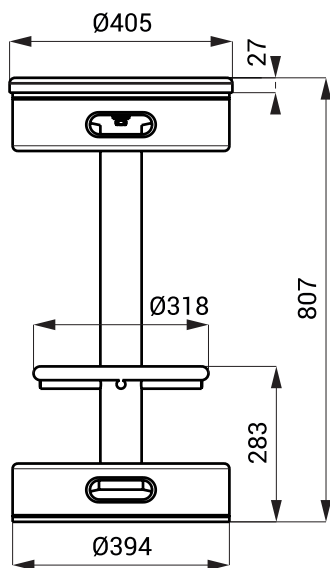

Supply Specification

SLZN 92 - Supply No. 85920 stainless steel bar stool, mounting set